

REVISIONS						
SHEET	ZONE	REV.	ECO	DESCRIPTION	DATE	APPROVED
1	ALL	NC	50242	REPLACE C101 AND C106 WITH AC1000103 AND AC1000009 RESPECTIVELY	4/28/2017	HRC
1	ALL	A	50253	2017 FORMAT UPDATE	5/7/2018	HRC

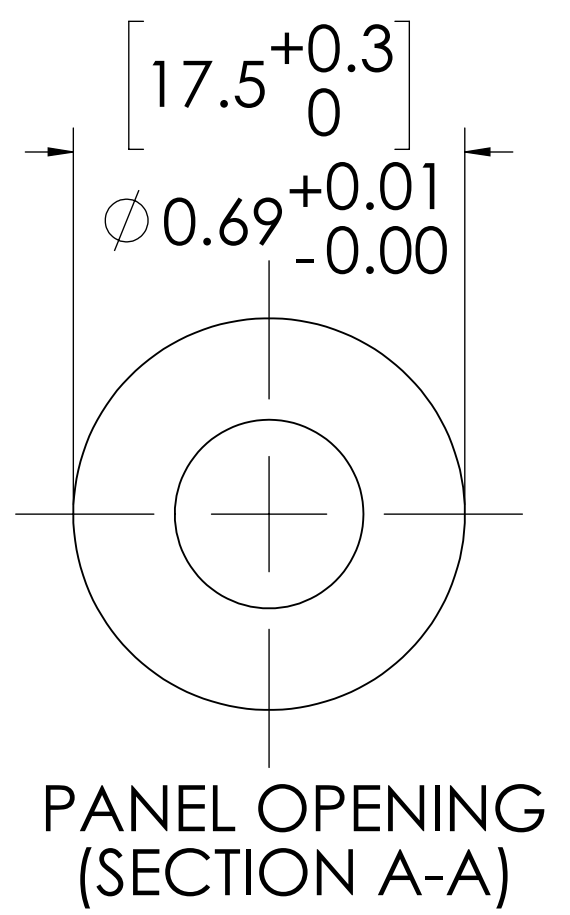
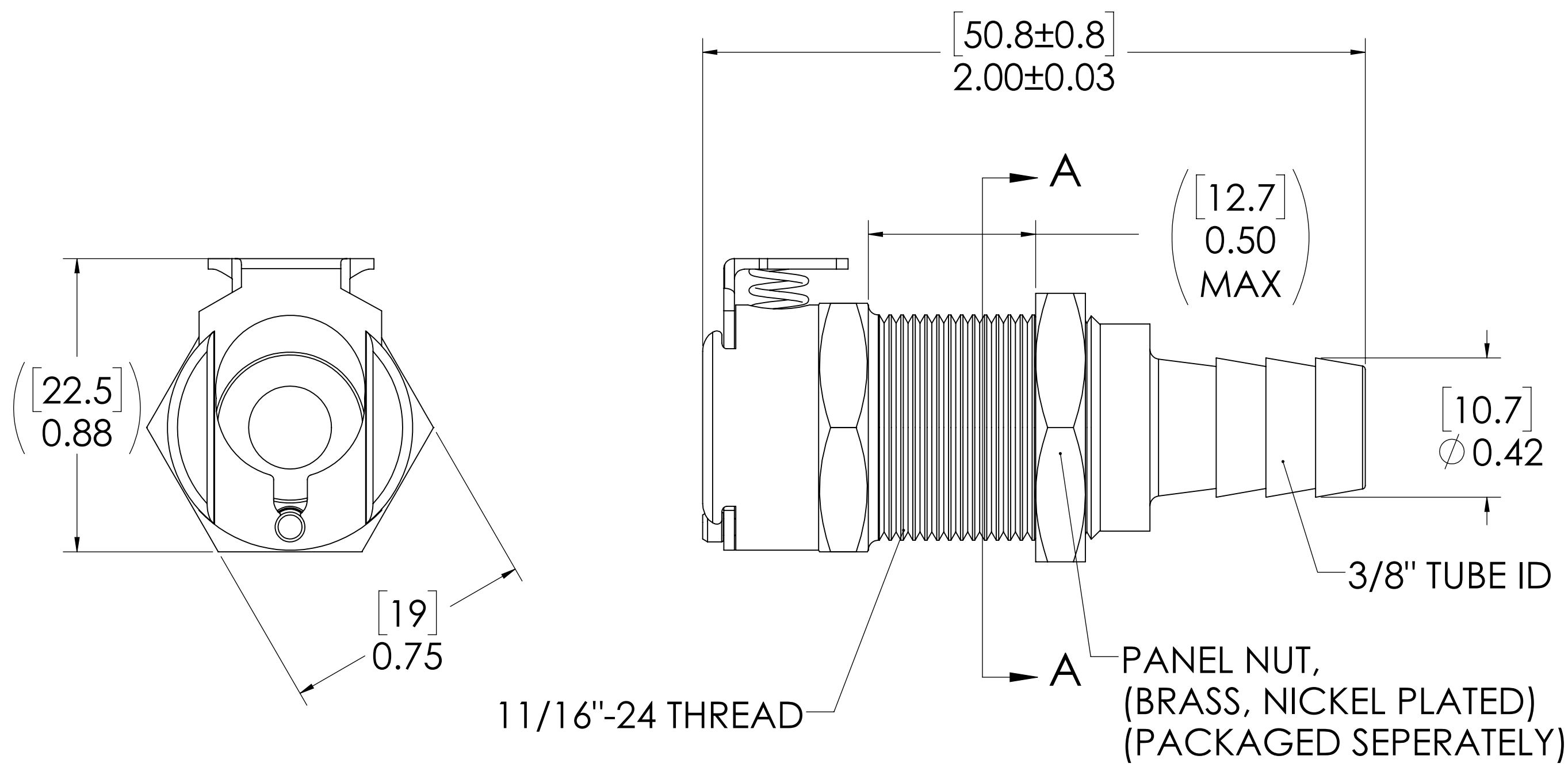
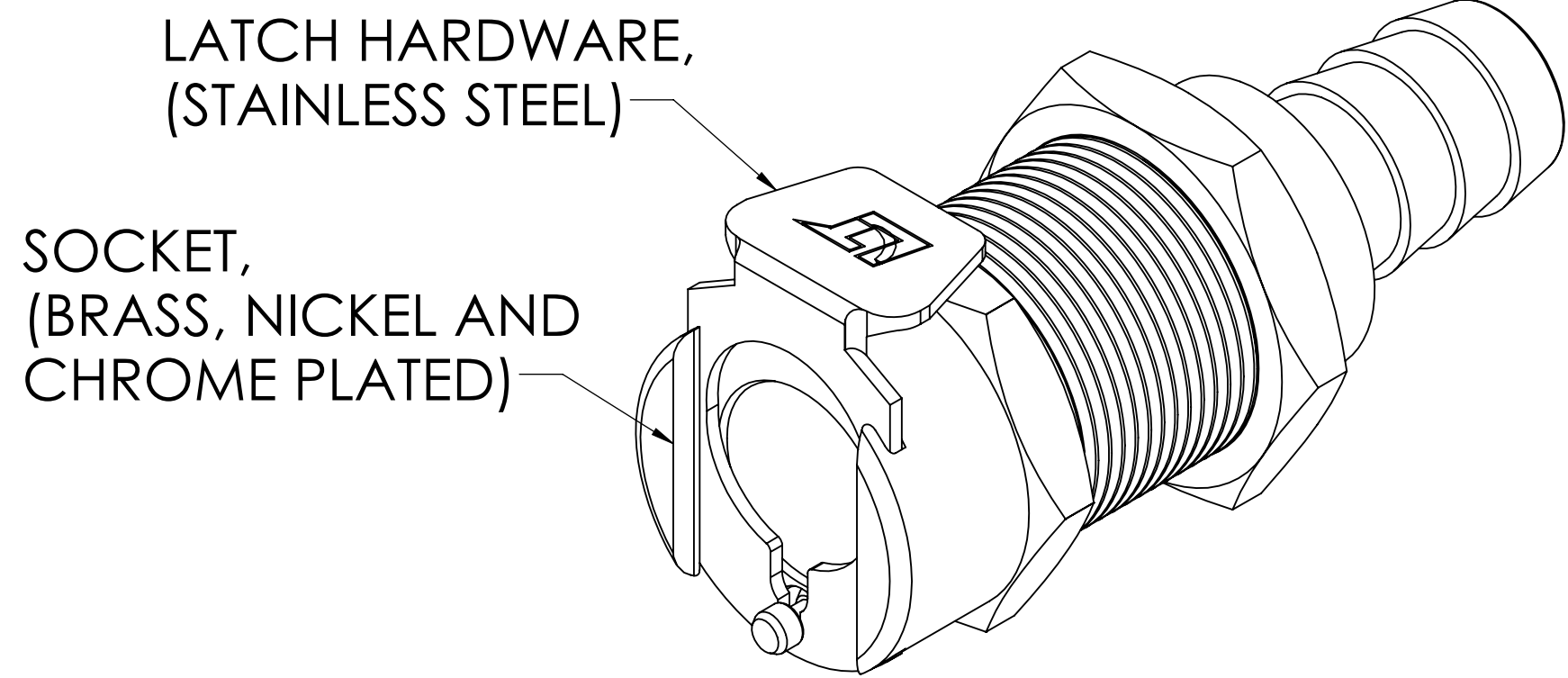

11/16"-24 THREAD

PANEL NUT, (BRASS, NICKEL PLATED) (PACKAGED SEPERATELY)

FOR REFERENCE ONLY

- NOTES:**
- MATERIAL: BRASS
 - FINISH: CHROME

<small>UNLESS OTHERWISE SPECIFIED: DIMENSIONS ARE IN INCHES TOLERANCES: FRACTIONAL ± 1/32 ANGULAR: MACH ± 0.5 BEND ± 2 ONE PLACE DECIMAL ± 0.1 TWO PLACE DECIMAL ± 0.01 THREE PLACE DECIMAL ± 0.005 TWO PLACE DUAL (mm) [±0.12]</small>	DRAWN	CKE	4/20/17	
	CHECKED	HRC	4/20/17	
	ENG APPR.	HRC	5/7/18	
	MFG APPR.	BDB	5/7/18	
<small>PROPRIETARY AND CONFIDENTIAL</small> <small>THE INFORMATION CONTAINED IN THIS DRAWING IS THE SOLE PROPERTY OF LINKTECH LLC. ANY REPRODUCTION OR DISCLOSURE IN PART OR AS A WHOLE WITHOUT THE WRITTEN PERMISSION OF LINKTECH LLC IS STRICTLY PROHIBITED.</small>	PURCHASING	RK	5/7/18	PART NO: 40CB-S3-06 DESCRIPTION: LinkTech 40CB Series Panel Mt. Female, Non-valved, 3/8" HB, Chrome Brass
SIZE DWG. NO. REV C 40CB400213 A		SCALE: NTS WEIGHT: SHEET 1 OF 1		